

2x2 Hybrid Combiner

HC-22-XX

Hybrid Matrix Signal Combiner with Built-in Monitoring Port

- 617-5925 MHz
- Built-In Monitoring Port
- Wall-Mountable
- IP67 Outdoor Rated
- Low PIM Rated
- 4.3-10 (F) Connector
- Compact Form Factor



Parameter	Specifications					
Model	HC-22-27		HC-22-60			
Freq. Range [MHz]	617-960	1710-2700	617-894	1710-2700	3300-4500	4900-5925
Insertion Loss [dB]	3.2±0.6	3.2±0.4	3.2±1.2	3.2±1.0	3.5±1.0	3.5±1.2
Port Isolation [dB]	25		25		21	
Coupling Value [dB]	32±3.0	30±3.0	33±4.0	25±4.0		33±5.0
Return Loss [dB]	18					
PIM [dBc]	-161					
Power Rating [W]	300					
IP Rating	IP67					
Operating Temp. [°F]	-13 to +140					
RF Connector	4.3-10 Female					
Size (W x H x D)	5.21" x 1.83" x 1.39"		4.81" x 1.83" x 1.22"			
Weight [lb]	1.5					

* Specifications are subject to change without prior notification.

Mechanical Drawing

HC-22-27

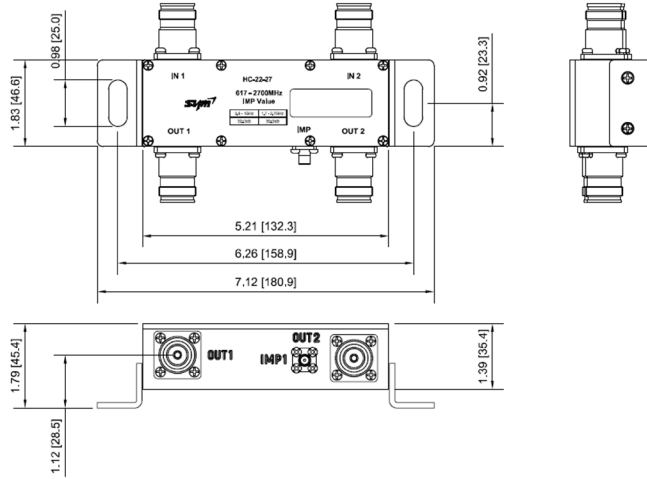

HC-22-60

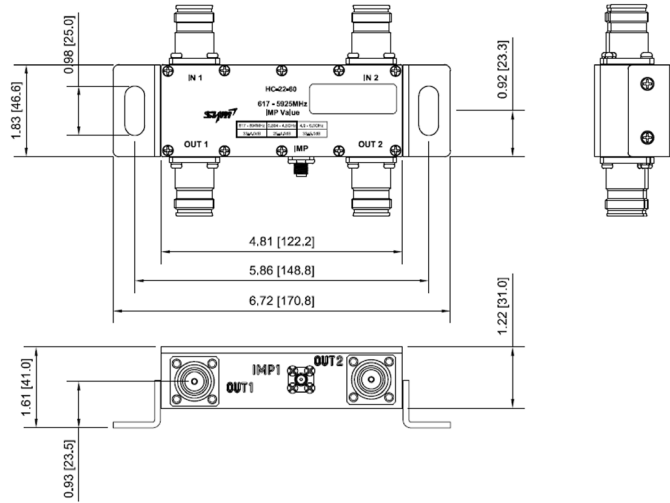

Inch [mm]

Mounting Bracket Options

HC-22-BR

Wall Mount Bracket for 2x2 Hybrid Combiner MIMO Installation

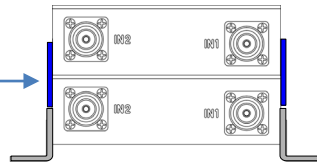
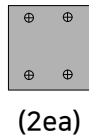

HC-22-RK

19" Rack Mount Bracket for 2x2 Hybrid Combiner

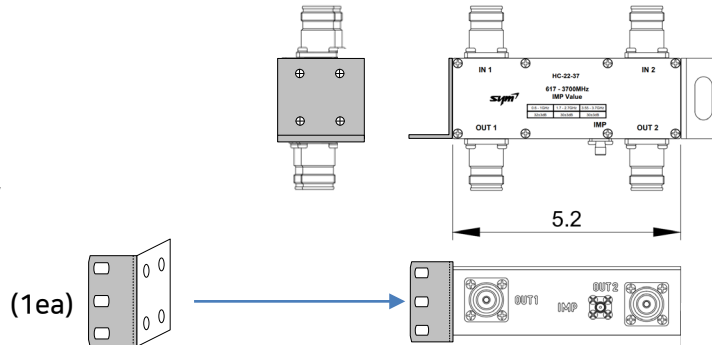

HC-22-RF

(1ea)

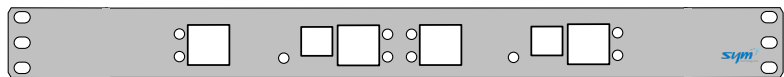

19" Rack Mount 1U Front Panel Bracket for installing two 2x2 hybrid combiners

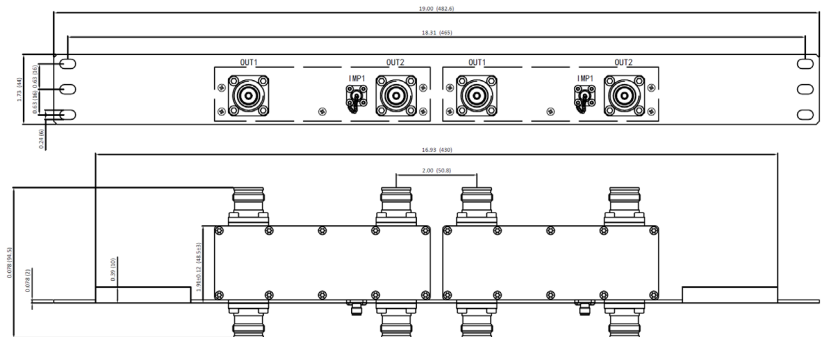

Model	Description
HC-22-27	Hybrid Combiner Matrix 2x2 with 1 Monitoring Port, 617-2700MHz, -161dBc, 300W, IP67 & 4.3-10 (F)
HC-22-60	Hybrid Combiner Matrix 2x2 with 1 Monitoring Port, 617-5925MHz, -161dBc, 300W, IP67 & 4.3-10 (F)
HC-22-BR	Wall Mount Bracket for 2x2 Hybrid Combiner MIMO Installation
HC-22-RK	19" 1U Rack Mount Bracket for 2x2 Hybrid Combiner
HC-22-RF	19" 1U Front Panel Bracket for installing one or two 2x2 Hybrid Combiners